

Belvoir Solar Farm Design Evolution Report.

EIA Screening Scheme 2021.

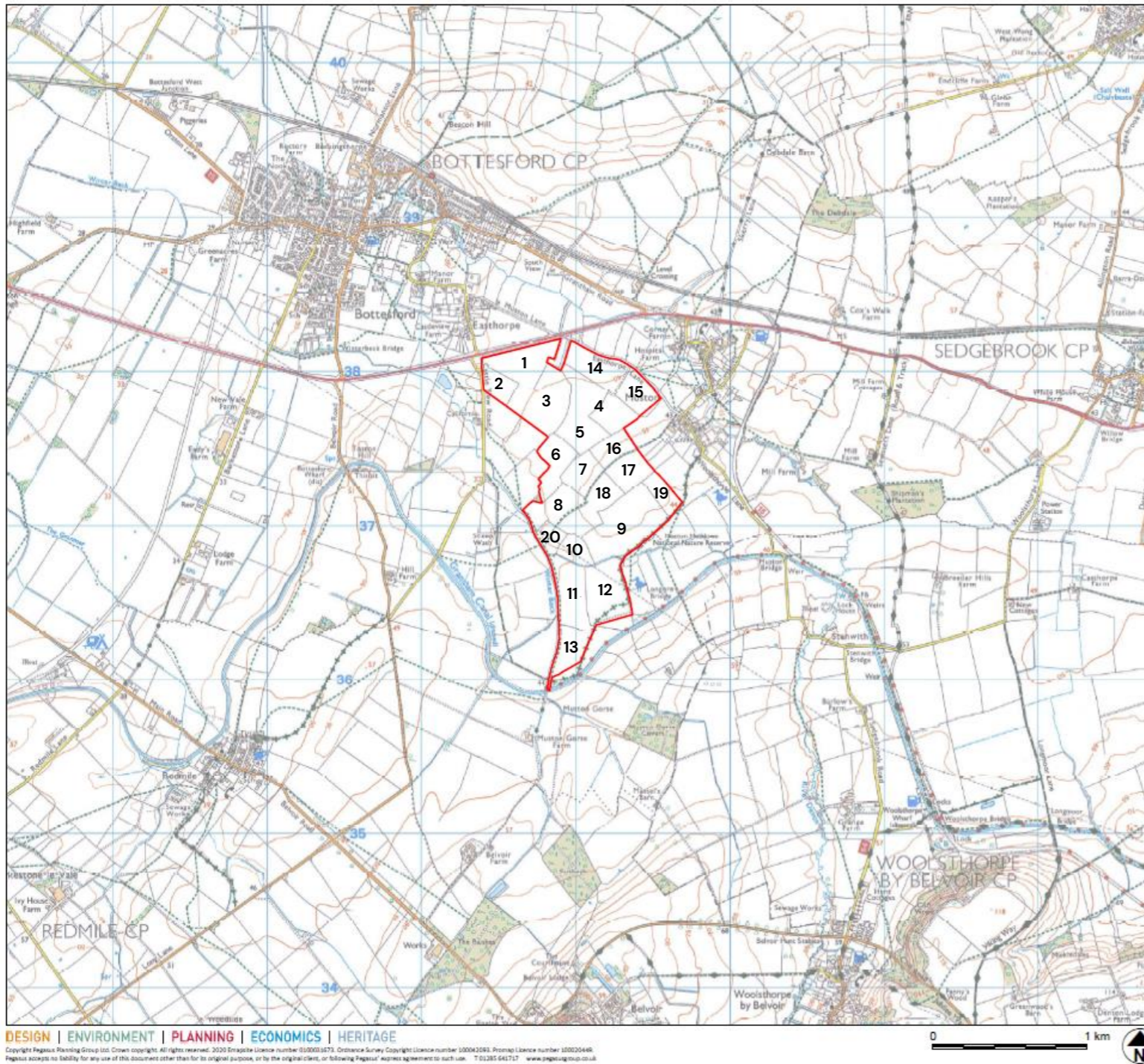

DESIGN | ENVIRONMENT | PLANNING | ECONOMICS | HERITAGE
 Copyright Pegasus Planning Group Ltd. Crown copyright. All rights reserved. 2020 Ordnance Licence number: 0100053679. Ordnance Survey Copyright Licence number: 100043089. Promote Licence number: 100020446.
 Pegasus accepts no liability for any use of this document other than for its original purpose, or by the original client, or following Pegasus' express agreement to such use. T: 01285 645717 www.pegasusgroup.co.uk

KEY
 Site Boundary

Plans Ref.	Submitted Via.	Design Considerations.
Site Location Plan, drawing number P19-2022_03 Revision A.	EIA Screening (Melton Borough Council reference: 21/00080/EIA).	All 20 fields considered.
Please note Field Numbers added to inform this document only.		

Revisions:
 First Issue- 03/02/2020 JS
 A - (20-04-2020 JS) Revised boundary

Site Location Plan

Belvoir Solar

Client: JBM Solar Projects Ltd
 DRWG No: **P19-2022_03** Sheet No: - REV: **A**
 Drawn by: JS Approved by: CR
 Date: 20/04/2020
 Scale: 1:25,000 @ A3



Pre-Application Scheme 2021 (Northern Parcels).



Plans Ref.	Submitted Via.	Design Considerations Following Pre-Application Discussions.
<p>Landscape Strategy, drawing number P19-2022_10 Revision A. (Comparison With P19-2022_10 and P19-2022_03 Revision A). Please note Field Numbers added to inform this document only.</p>	<p>2021 Pre-Application (Melton Borough Council reference: 19/01312/ENQMG, following pre-application submission in November 2019 and a site walkover carried out by Officers in August 2020).</p>	<p>Following pre-application discussions with the Local Authority in 2019 and Historic England in early 2021, the Site reduced in size and the red line was pulled in with central areas excluded. Fields 14, 15, 16, 17, 18, 19 and 20 removed.</p> <p>Following additional feedback from Historic England (October 2021, Reference: PA01126125), further revisions were subsequently incorporated to the Site Layout and Landscape Strategy to address Historic England's comments. These amendments included additional planting of trees to soften views, setback of solar panels from public rights of way ("PRoW's") as well as the inclusion of heritage information and interpretation boards. Please see the submitted Planning Statement for further information on the pre-application process (Section 1, Core Document 1.24).</p> <p>Summary of Changes:</p> <ul style="list-style-type: none"> • Minor adjustment to the position of panels site wide for technical optimisation purposes. • Panels pulled away from alignment of PRoWs. • Reduction in the number of panels, inc. set back from PRoWs and the eastern edge. • Additional landscaping incorporated.

Pre-Application Scheme 2021 (Southern Parcels).



Application Submission Scheme April 2022 (Northern Parcels).



Plans Ref.	Submitted Via.	Change From Previous Iterations
<p>Site Layout & Landscape Strategy, drawing number P19-2022_10 Revision L.</p> <p>(Comparison With P19-2022_10 Rev A)</p> <p>Please note Field Numbers added to inform this document only.</p>	<p>Application Submission Scheme (Melton Borough Council reference: 22/00537/FUL)</p>	<p>Reduced redline and number of panels. Development further pulled back from Muston, Easthorpe Lane and Scheduled Grange. Fields 14 and 15 removed from red line, panels omitted. Change made in response to further Historic England Pre-Application comments.</p> <p>Minor adjustment to the position of panels site wide for technical optimisation purposes.</p> <p>Swales added site wide.</p> <p>Suitable skylark mitigation areas added site wide. Ecological features added site wide.</p> <p>Field 1/3 – Area of tussock grassland added outside of fence line surrounding pond.</p> <p>Field 2 – Areas of tussock grassland added outside of fence line surrounding ponds.</p> <p>Field 7 – Hedgerow added along eastern boundary fence line.</p> <p>Field 7/8 – Small copse added adjacent to PRow to screen views of panels.</p> <p>Field 9 – 10m wide native tree planting buffer added to boundary with adjacent Muston Meadows SSSI.</p> <p>Field 9 – Small area of complimentary species diverse grassland habitat added adjacent to Muston Meadows SSSI.</p> <p>Field 10 – Trees added to proposed hedgerow along western boundary.</p> <p>Field 13 – Orchard added.</p>

Application Submission Scheme April 2022 (Southern Parcels).

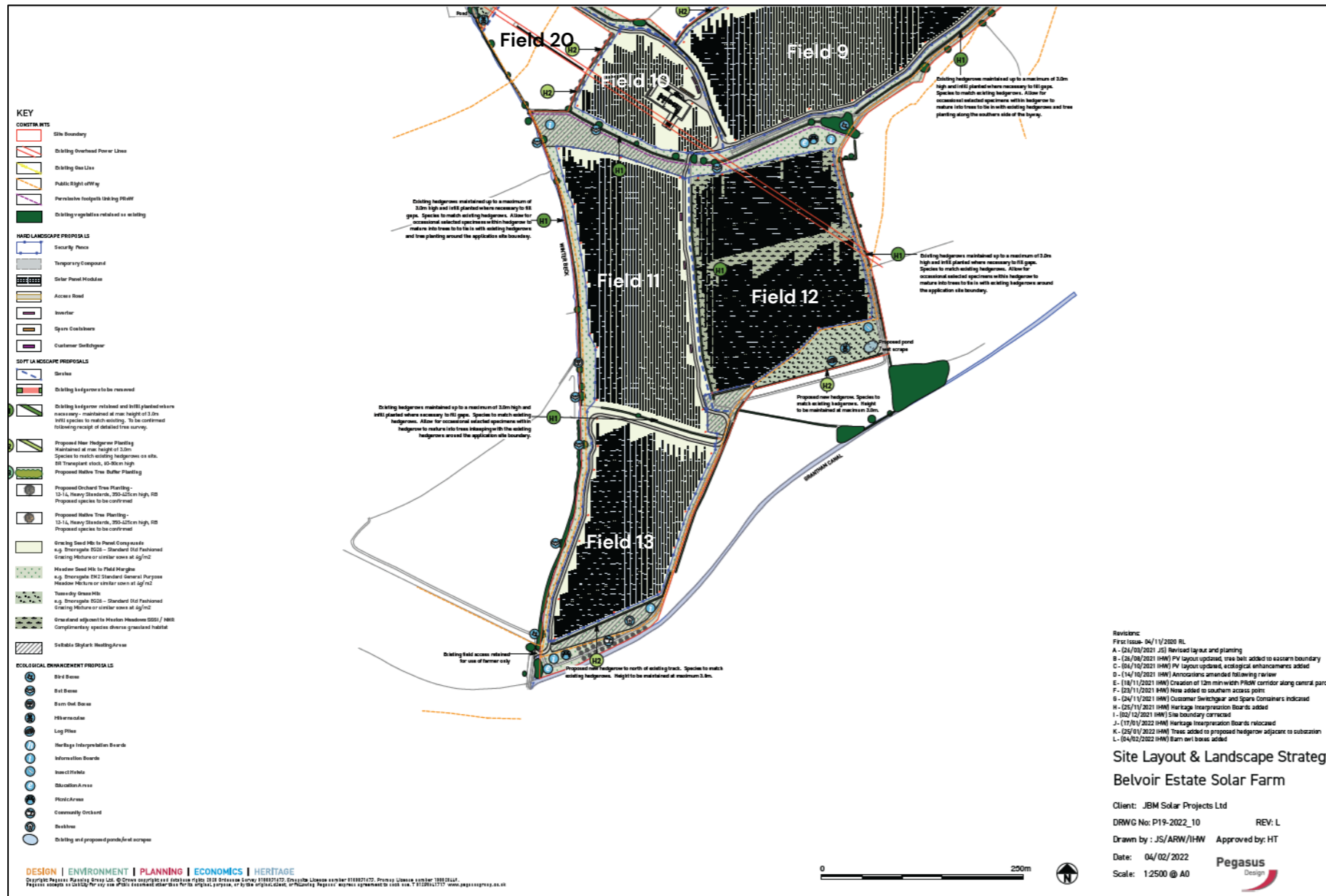

Application Refused Scheme September 2023 (Northern Parcels).

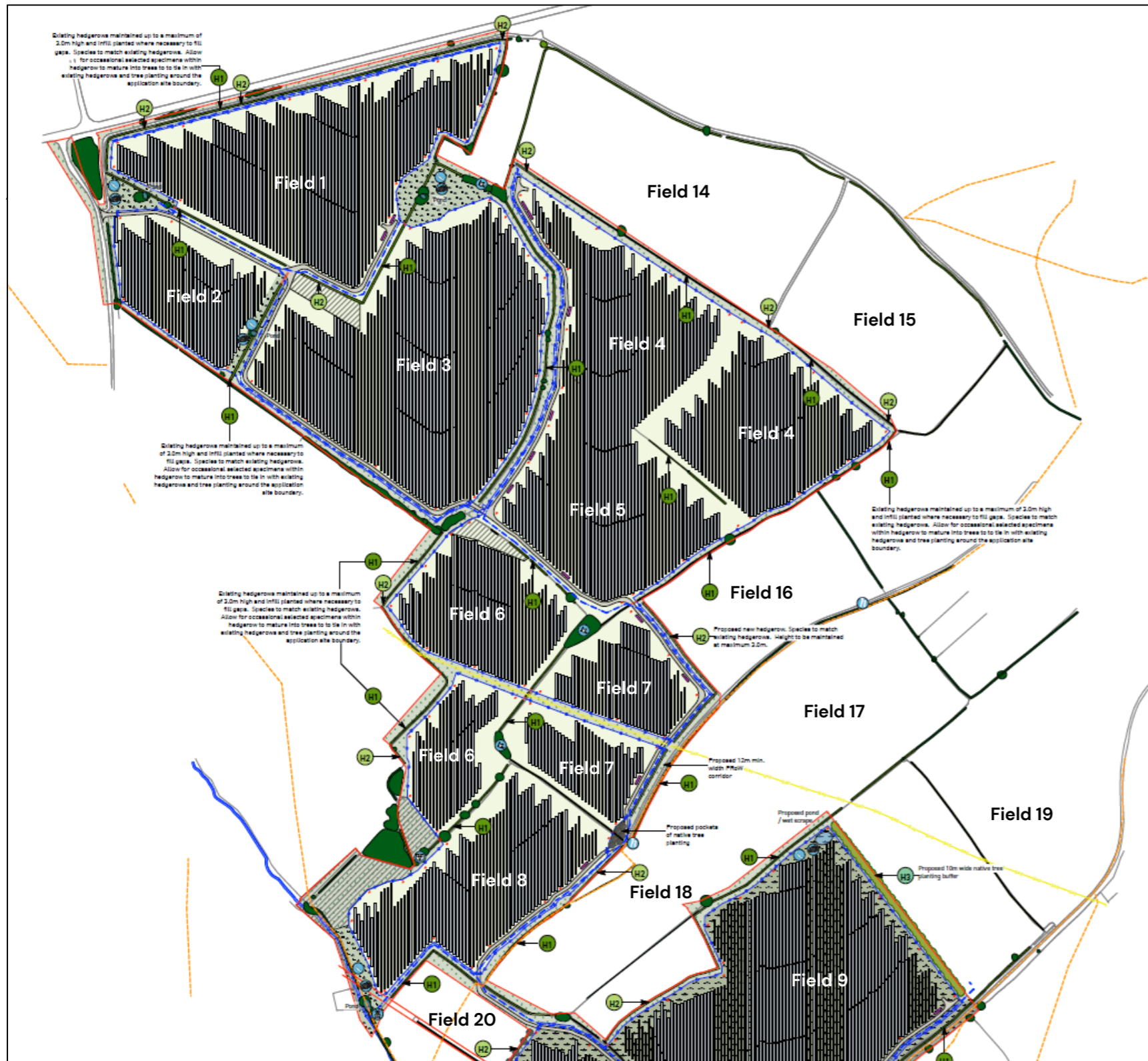

Plans Ref.	Submitted Via.	Change From Previous Iterations
<p>Site Layout and Landscape Strategy, drawing number P19-2022_10 Rev Q.</p> <p>(Comparison With P19-2022_10 Rev L)</p> <p>Please note Field Numbers added to inform this document only.</p>	<p>Refused Scheme (Melton Borough Council reference: 22/00537/FUL), revised during the course of the application determination period.</p>	<p>Removal of 7.63 acreage of solar PV panelled area to the east, closest to Muston (part of Field 9). Entire site area reduced to approximately 99.95ha. This followed consultation with the Parish Councils.</p> <p>Field 9 – 10m wide native tree planting buffer on eastern boundary pulled in to revised red line.</p> <p>Minor adjustment to the position of panels site wide for technical optimisation purposes.</p> <p>Red line amended to site access, increased visibility splay, in response to Highways consultee comments (<i>Core Document 7.7</i>).</p> <p>Minor transport amendments (including internal track arrangements, access, gates and compound) detailed further in the submitted CTMP Addendum (August 2022) (<i>Core Document 1.29</i>).</p> <p>Field 8 – Red line extended on western boundary. Field 9 – Red line pulled in on eastern boundary.</p> <p>Fields 9, 10 and 12 amended to complimentary species diverse grassland habitat added adjacent to Muston Meadows SSSI, extended by 0.62ha. These changes were made in (<i>Core Document 1.35</i>) in response to Natural England (<i>Core Document 7.10</i>) and CEC Environment consultee comments (<i>Core Document 7.19</i>).</p>

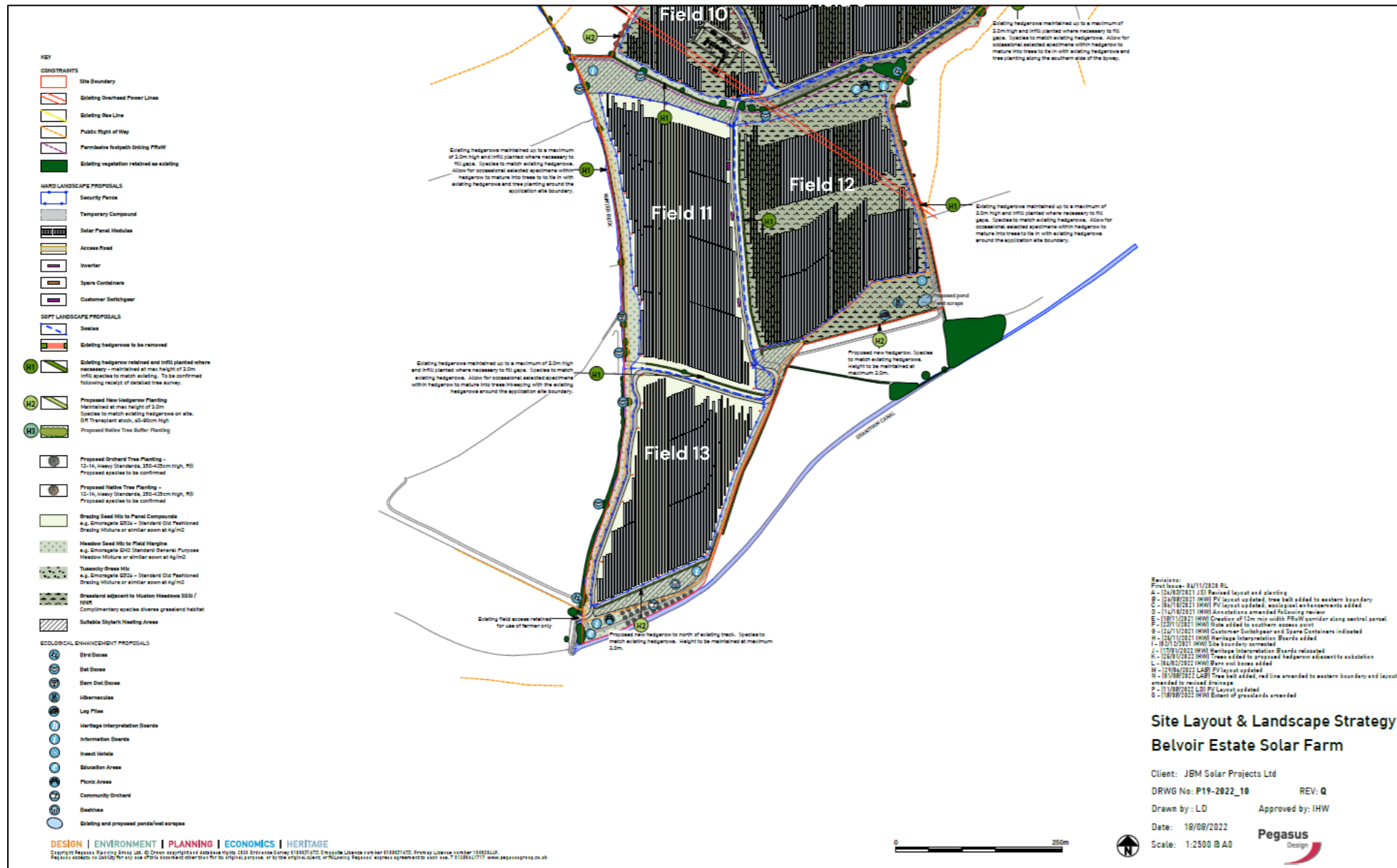

Holborn Amended Scheme (Northern Parcels) – Appeal.



Plans Ref.	Submitted Via.	Change From Previous Iterations
Amended Scheme Site Layout and Landscape Strategy, drawing number P19-2022_24 Rev C (Comparison With P19-2022_10 Rev Q)	Holborn Amended Scheme, consultation ran from 7 th March 2024 to 20 th June 2024, as part of Appeal 3340258. Please refer to Clarification Note (Core Document 2.5).	<p>Red line minorly amended to site access.</p> <p>Trees added along site access track hedgerow.</p> <p>Field 4 – Red line minorly extended on eastern boundary to include existing hedgerow.</p> <p>Field 7 – Trees added to proposed hedgerow along eastern boundary.</p> <p>Field 8 – Red line pulled back in on western boundary.</p> <p>Field 8 – Hedgerow with trees added along eastern, southern and western boundary fence lines.</p> <p>Field 9 – Hedgerow with trees added along western boundary fence line.</p> <p>Field 9 – Trees proposed along western boundary and southern existing hedgerows.</p> <p>Field 10 – Trees proposed along western boundary existing hedgerow.</p> <p>Field 11 – Hedgerow with trees added along northern and western boundary fence lines.</p> <p>Field 11/13 – Trees proposed along existing hedgerow between fields.</p> <p>Field 12 – Hedgerow with trees added along northern, eastern and southern boundary fence lines.</p> <p>Extent of solar panels reduced (by just over 2.2 hectares) in Field 13 to retain the view towards Belvoir</p>

Holborn Amended Scheme (Northern Parcels) – Appeal.

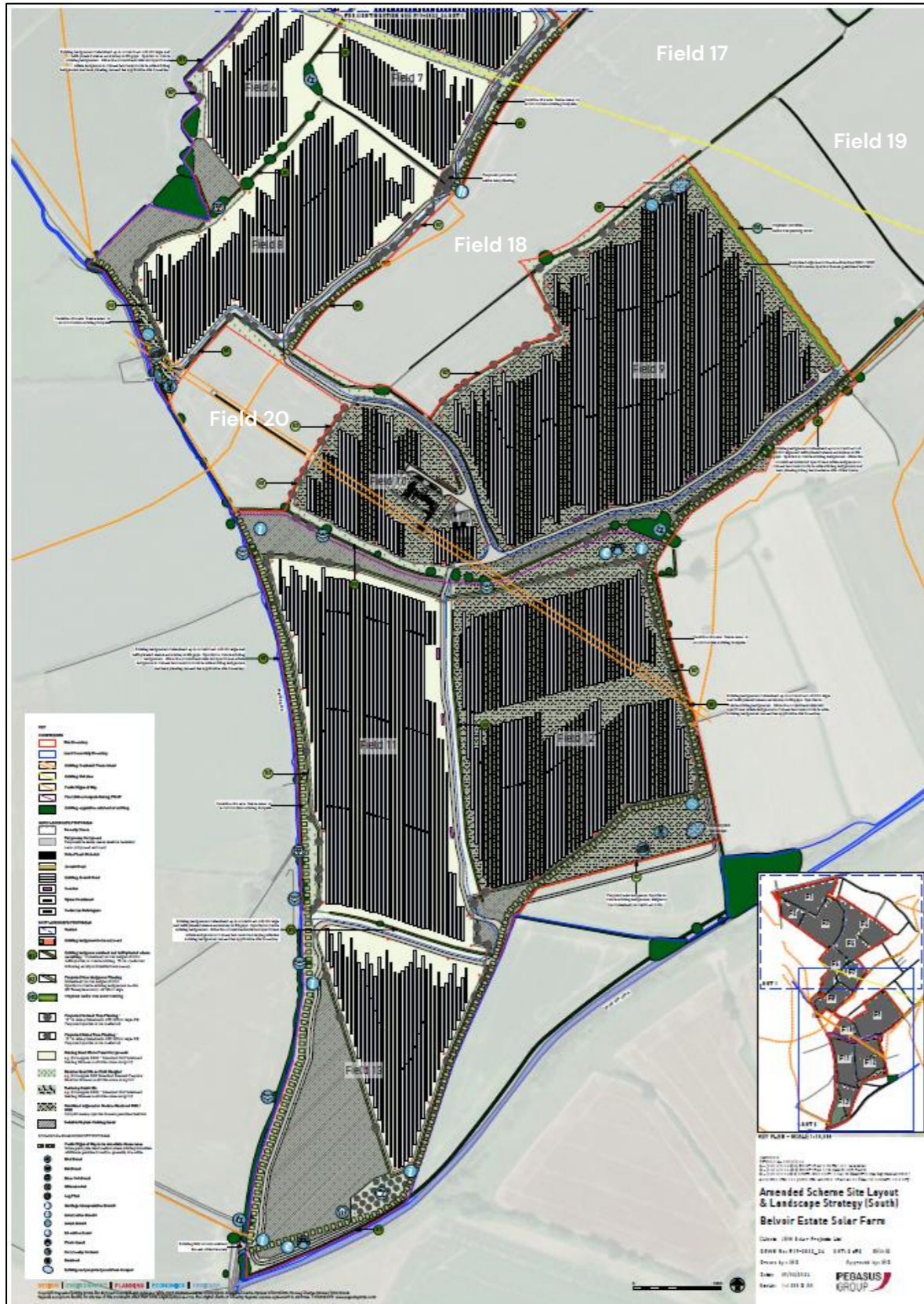

	<p>Castle and to provide an extended area of open space.</p> <p>Orchard tree planting in Field 13 moved eastward to open up views of Belvoir Castle for walkers and users of the recreational area.</p> <p>Additional information board has now been added to inform users of the PRoW of the view towards Belvoir Castle, this will include details of the history and heritage value of Belvoir Castle.</p> <p>Changes made to reduce changes to the visibility and experience of Belvoir Castle in the southwestern part of the Site and improve public experience of the Castle in this location (when compared to P19-2022_10 Rev Q).</p> <p>Green Lane's annotation incorporated to the Holborn Amended Scheme Plan to denote footways for public use. Public Right of Way to be set within Green Lane's with mown grass path (hard surface where existing) set within wildflower grassland corridor, generally 6m+ width.</p>
--	--